

Independent Jaguar Spares Specialist

E-Type, 420, S-Type, MK10, 420G, XJ6, XJ12, & XJS Rear Suspension

Stainless steel locking wire, the correct gauge that's not easy to find. C21126 sold by the metre

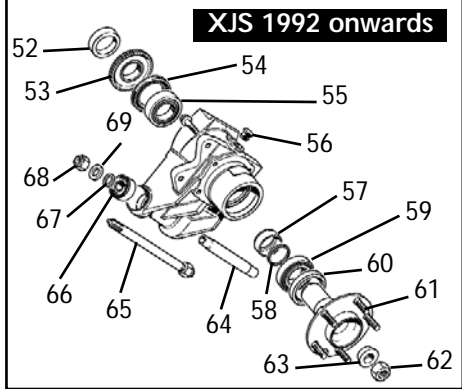

IRS driveshaft U-Joint covers
Often missing or damaged by replacing UJs and every IRS Jaguar has them! C28844*/C23616*

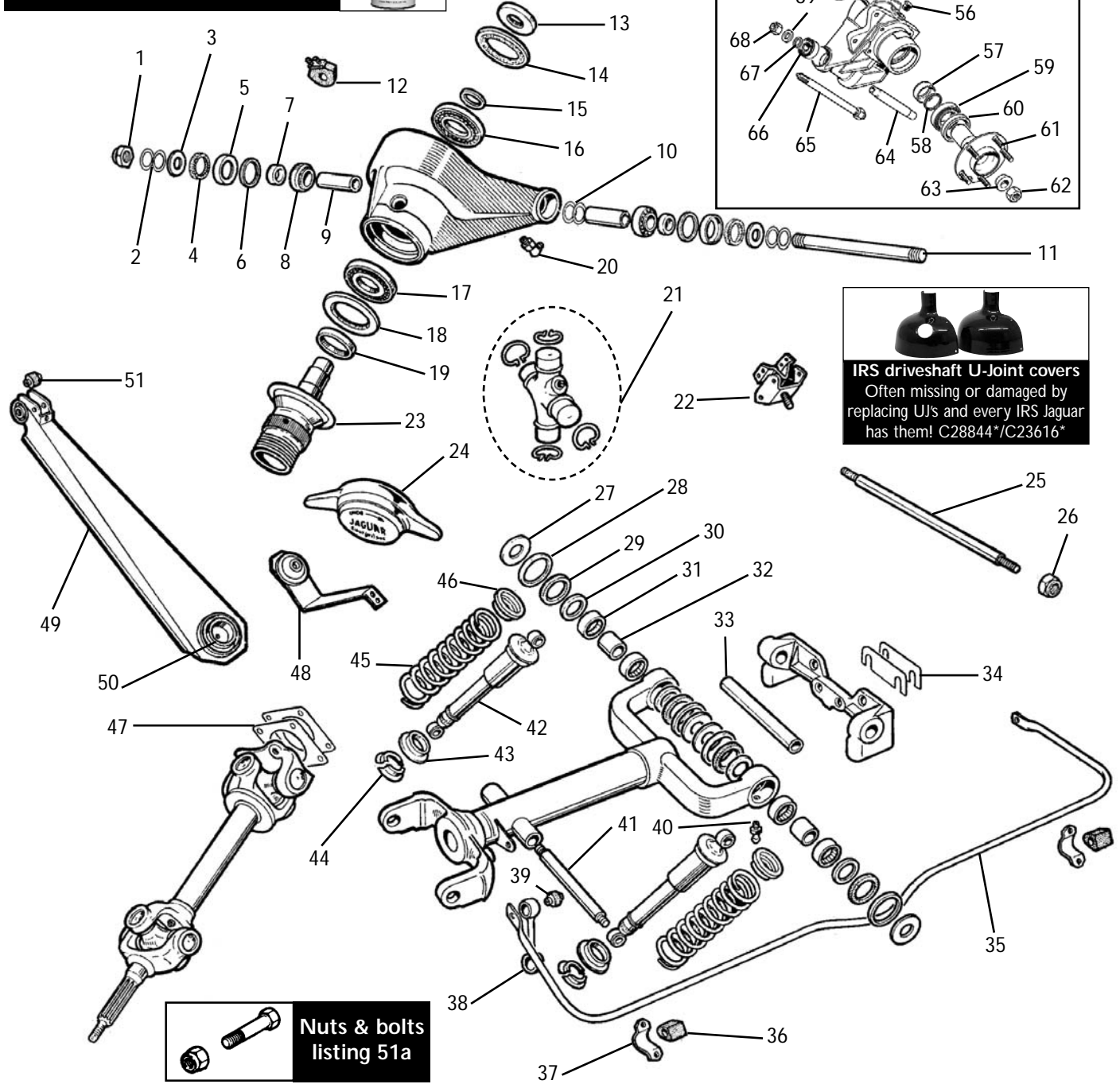

Nuts & bolts listing 51a



Independent Jaguar Spares Specialist

**E-Type, 420, S-Type, MK10, 420G, XJ6,
XJ12 & XJS Rear Suspension**

Outer Fulcrum

1. Nut	C8667/4	
2. Shim	C16626/1	0.003"
	C16626/2	0.007"
3. Retaining washer	C20182	
4. Felt oil seal	C20178	
5. Oil seal retainer	C20179	
6. Spacer	C20180	
7. Seal seating ring	C16628	
8. Outer fulcrum shaft bearing	C16029	
9. Sleeve		
	to 1974	C16623
	1974 on	C16623/1
10. Shim	C16626	0.004"
	C16626/3	0.007"

Items 1-10 are available as an outer fulcrum repair kit C16029FK which contains enough parts for one side.

11. Outer fulcrum shaft		
	to 1974	C16624
	1974 on	CAC2316
12. Bump stop		
E-Type	C25938	
All other models	C40158	
13. Seating ring for inner oil seal	C15232	
14. Inner hub oil seal	C15231±§	
15. Hub bearing spacer various sizes	CCC6806	10 to 50
16. Inner hub bearing	C15230±§	
17. Outer hub bearing	C19066±§	
18. Outer hub seal		
E-Type S1 3.8 & S1 4.2 to 1E1236/ 1E10978/1E20638/1E31002	C19068§	
All other models	C24789±	
§ Included in early rear wheel bearing kit JLM9732E		
± Included in late rear wheel bearing kit JLM9732		
19. Seal seating ring		
E-Type S1 3.8 & S1 4.2 to 1E1236/ 1E10978/1E20638/1E31002	C19067	
All other models	C24791	
20. Grease nipple	C9048	

21. Drive shaft universal joint	JLM9639
22. Cradle mounting	
E-Type, 420, S-Type	C17198
MK10/420G	C18104
XJ6/XJ12/XJS	CAC3067

23. Wire wheel splined hub
C20889 RH C20890 LH
Turn to page 94 to see our full range of Dayton Wire Wheels

24. Chrome spinner		
<u>Two eared</u>		
Jaguar	RH C1102	LH C1103
Daimler	RH C1102D	LH C1103D
<u>Three eared</u>		
Jaguar	RH C28684	LH C28685
Daimler	RH C21270	LH C21271

Inner Fulcrum

25. Inner fulcrum shaft	C17008	
26. Nut	NY608041J	
27. Thrust washer	C17165	
28. Oil seal retainer	C17936	
29. Sealing ring	C17213	
30. Thrust washer	C17166	
31. Inner fulcrum shaft bearing	C17167	
32. Bearing tube		
	E-Type 3.8	C17168
	All other models	C17168/1

Items 26-32 are available as an inner fulcrum repair kit C17167FK which contains enough parts for one side.

33. Fulcrum shaft distance tube	C17663/1
34. Shim	C17722 0.005"
	C17723 0.007"

35. Anti roll bar		
E-Type S1/2	C17151 std	SBS1090 uprated
XJS	C42178/2	

36. Anti roll bar mounting bush	
E-Type S1/2	C16633 std/C16633U polyurethane
Most XJS with rear roll bar	C44931/2
XJS 3.6 87 on	CBC4901

37. Anti roll bar mounting bracket	
E-Type S1/2	C3054
XJS	C42907

*Independent Jaguar Spares Specialist*

38. Anti roll bar link			
	E-Type S1/2		C20765
	XJS		C42907
39. Anti roll bar link bush		C10940 std/C10940U poly	
40. Grease nipple			
	Early models		C3044/1
	Later models		234532
41. Shock absorber mounting shaft		C17013	
42. Shock absorber			
E-Type S1/2	Std C25951	Koni 80-1491	Gaz C25951GAZ
E-Type S3	Std C32061	Koni 80-2216	Gaz C32061GAZ
S-Type/420	Std C22847	Koni 80-1572	Gaz C22847GAZ
MK10/420G	Std C22847	Koni 80-1572	Gaz C22847GAZ
XJ6/12/XJS	Std CAC9091	Koni 80-2094	Gaz CAC9091GAZ
43. Spring seat			
	E-Type S1/2		C19820±±
	E-Type S3		C37271±±
	S-Type/420/MK10/420G		C19821±±
	XJ6/XJ12/XJS		C37272±±
44. Split collet			
	E-type S1/2		8687±±
	E-Type S3		C37273±±
	S-Type/420/MK10/420G		8687±±
	XJ6/XJ12/XJS		C37273±±
±± For use with original style of shock absorbers only			
45. Coil spring			
	E-Type S1/2		C25939
	E-Type S3		C32062
	S-Type/420		C23167
	MK10/420G		C21280
	XJ6/12		JLM11569
	XJS		C39692
46. Packing ring			
	E-type S1/2		C19027
47. Shim			
			C16621
48. Radius arm safety strap			
	E-Type SWB		C19031
	E-Type LWB		C25156
	S-Type/420/MK10/420G		C42220
	XJ6/XJ12/XJS		C42220

49. Radius arm with bushes			
	E-Type SWB		C23824
	E-Type LWB		C37945
	S-Type/420		C23824
	MK10/420G		C23824
	XJ6/XJ12/XJS		C41831
50. Large radius arm bush			
			MHC3170AA
Bolt through bush			
			CBC9362
51. Small radius arm bush			
			MHC3160AA
Bolt through bush			
	Pre V12E models	C17149/1	83mm
	XJ/E-Type S3	C25365	76mm
51a. Nuts & bolts			
	Cradle mounting to body bolt		SH605071J x 8
	Cradle mounting to body bolt		UFS131/25R x 8
	Nut for cradle mounting bolt & studs		NY605041J x 20
	Shock absorber top mounting bolt		BH607171 x 4
	Shock absorber top mounting bolt-nut		NY607041J x 4
	Nut for shock absorber lwr mtg shaft		NY607041J x 4
	Safety strap to body bolt		SH605061J x 2
	Brake disc retaining nut		C24119/4 x 8
<u>XJS 1992 Onwards With Outboard Brake Discs</u>			
52. Seal track spacer (non ABS)		CAC7216	
53. ABS sensor rotor		CBC4705	
54. Inner hub seal		CBC1706	
55. Inner hub bearing		CAC6332	
56. Blanking plug		CAC7452	
57. Bearing spacer		CAC5825	
58. Adjustable spacer (various sizes)		CBC9505	1 to 26
59. Outer hub bearing		CAC6333	
60. Outer hub seal		CAC8663	
61. Wheel stud		CAC3878	
62. Hub nut		CBC7355	
63. Collar		CBC6652	
64. Sleeve		CAC5846	
65. Outer pivot pin		CBC2589	
66. Bearing		CAC4610	
67. Adjustable spacer (various sizes)		CBC1537	1 to 10
68. Nut		NY114041J	
69. Washer		CBC2562	

