

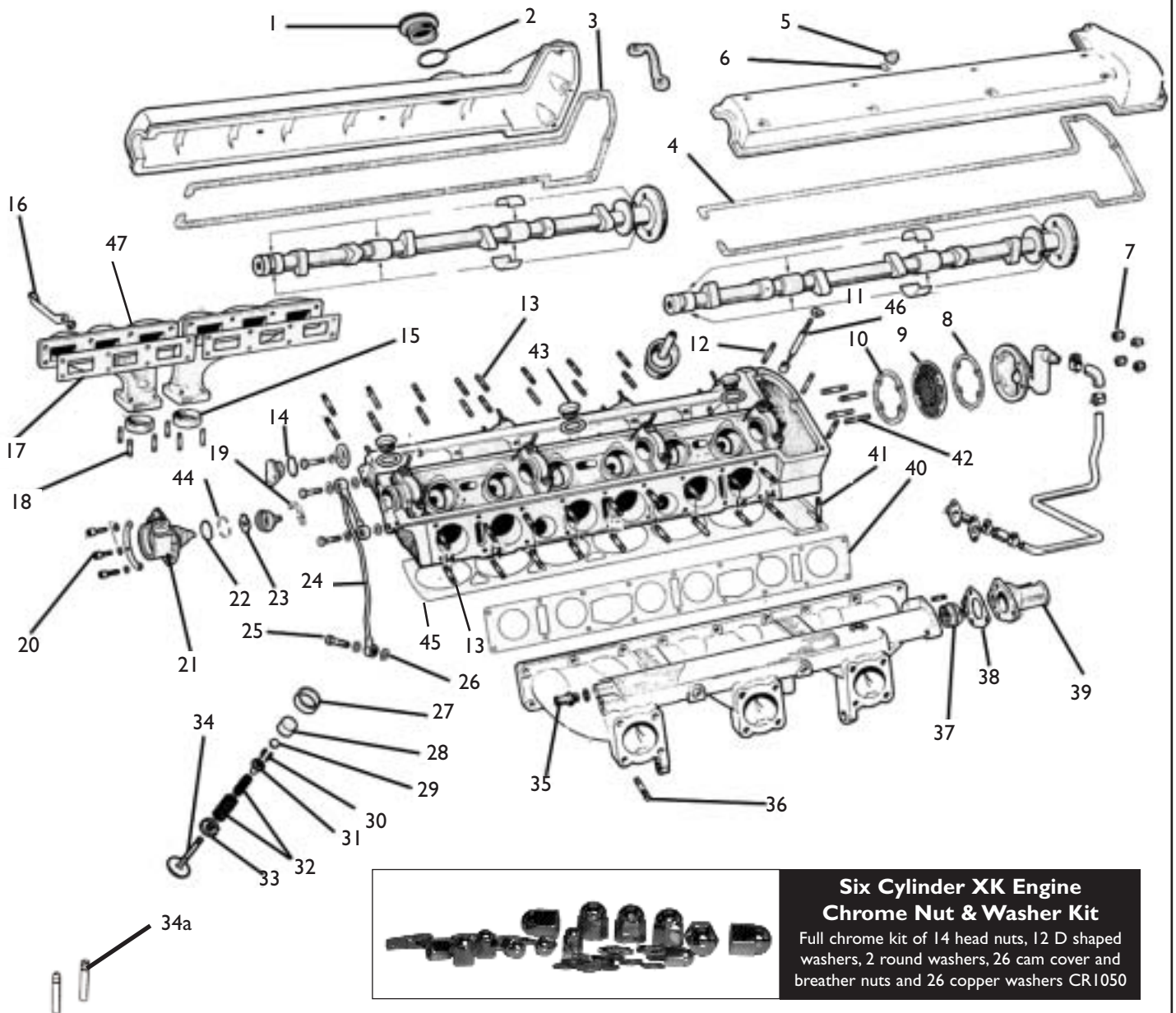

Tappet guide hold down kit

Stops them coming loose!
One kit per cam SBS9219.

**6 Cylinder XK Type Cylinder Head
2.4,2.8,3.4,3.8 & 4.2 Carburettor & Injection**



**Six Cylinder XK Engine
Chrome Nut & Washer Kit**
Full chrome kit of 14 head nuts, 12 D shaped washers, 2 round washers, 26 cam cover and breather nuts and 26 copper washers CR1050



Independent Jaguar Spares Specialist

6 Cylinder XK Type Cylinder Head 2.4,2.8,3.4,3.8 & 4.2 Carburettor & Injection		
1. Oil filler cap		
Round polished Jaguar	C1022	
Orange/red eared	EAC6523	
2. Sealing ring		
MK7/8/9/XK/MK1 early MK2/ E-Type SI 3.8/MK10 3.8	C419	
All other models	C25480	
3. Cam cover gasket LH		
Split type to 1975	C6735/1	
Solid type 1975 on	EAC5039	
4. Cam cover gasket RH		
Split type to 1975	C14988/1	
Solid type 1975 on	EAC5039	
5. Cam cover nut		
	C2327	
6. Cam cover washer		
	FW104E	
7. Breather cover nut		
	C2327	
8. Breather cover gasket		
	C2227	
9. Breather gauze		
	C37282	
10. Breather cover gasket		
	C2227	
11. Camshaft bearing set		
	RTC2347	
12. Camshaft cover stud		
(not early XK120)	C6727/1	
13. Manifold attachment stud		
Inlet & exhaust all models	C11761	
14. Sealing ring		
MK7/8/early MK9	C2312	
All other models	C19044	
15. Exhaust seal		
MK7/8/ early MK9/XK/MK1	C495	
All other models	EBC9388	
16. Dipstick bracket (most models)		
	C15848	
17. Exhaust manifold gasket		
	C2318	
18. Exhaust downpipe stud		
	C2369	
19. Generator seal		
	C14991	
20. Fixing screws		
	C14992	
21. Rev counter generator		
XK120/140/MK7/8 Early MK9	C2153/1	

Early XK150/MK1	C9914	
Late XK150/Late MK9/E-Type SI	C14996	
MK2/S-Type/MK10/420G		
22. Sealing ring		
	C14990	
23. Drive dog		
MK7/8/Early MK9/XK140	C2176	
Early XK150/MK1		
Late MK9/Late XK150/E-Type SI	C25426	
MK2/S-Type/MK10/420G		
24. Camshaft feed pipe (not 2.4/2.8)		
	C25619	
25. Banjo bolt		
	C5846	
26. Sealing washer		
	C4146	
27. Valve insert		
Inlet (most models)	C29122 Carb	EAC1953 Injec
Exhaust	C291241	
28. Tappet		
	C44010	
29. Tappet gap shim		
0.001 increments	C2243A to Z	
(Add P i.e. C2243AP for 0.0005 increments)		
30. Valve cotter		
	C27482	
31. Valve collar		
	C27480	
32. Valve spring set		
	VSP480P	
33. Valve spring seat		
	C27481	
34. Engine Valves		
Inlet	XK120/MK7	C2246
	All other models	EAC1547Carb
		EAC1395 Injec
Exhaust	XK120/MK7	C2247
	All other models	EAC1548
34a. Valve guides		
	Steel	Bronze
Inlet	VAG92198 1st o/s	ENG102
	VAG50914 2nd o/s	ENG102/1
Exhaust	VAG92199 1st o/s	ENG103
	VAG50913 2nd o/s	ENG103/1
35. Adaptor		
	C17421	

SNG Barratt USA, 92 Londonderry Turnpike, Manchester, New Hampshire 03104, USA.
 Telephone 603-622-1050 Orderline 1-800-452-4787 Fax 603 622 0849
 E-Mail sales.usa@sngbarratt.com Website www.sngbarratt.com



Independent Jaguar Spares Specialist

36. Carburettor stud		C18232
37. Thermostat (use the photo to identify the type you have)		
Bellows type 70-75 degree		C3731/I
Foot type 74 degree		C28067
82 degree		EBC3576
88 degree		EBC3577
Plain type 74 degree		C27650
82 degree		C27650I



38. Thermostat gasket

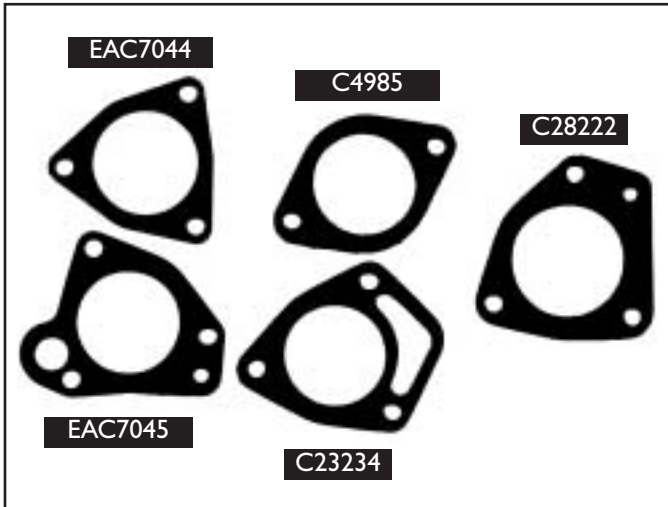

39. Thermostat housing

There are too many different types to list, please contact us with the exact model of your vehicle and your engine number .

40. Inlet manifold gasket

E-Type 3.8/MK10 3.8		C14127/I
MK7/8/9/XK120/140/150		C7619/I
MK2 3.4/3.8/S-Type		C7619/I
240/340/E-Type 4.2/MK10 4.2/420G		C23232/I metal
XJ6		C41247 paper

41. Stud		C2189
42. Stud		C6727
43. Threaded plug		C2157
44. Circlip		C16773

45. Head gasket

2.4/3.4 early		C19112
2.8		C35597
3.8		C19113
4.2 early		AG570
3.4 late		EAC8349
4.2 late		NXD2520AA

46. Cam cover stud

C2326

47. Exhaust manifold

E-Type 3.8/4.2 front		C18396
E-Type 3.8/4.2 rear		C18397
XK120/140/150 front		C2213
XK120/140/150 rear		C2214

