

6 Cylinder XK Type Engine Block 2.4, 3.4, 3.8 & 4.2

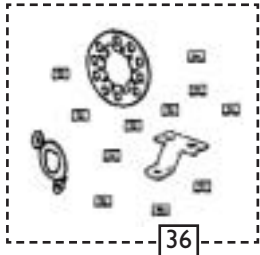

Spare Your Garage Floor!!!
 Simply the largest drip tray that we have ever seen. Covers the sump and is long enough to catch any drips from the gearbox. Or you can use it to bake the worlds largest swiss roll! SBS1702

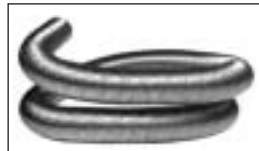
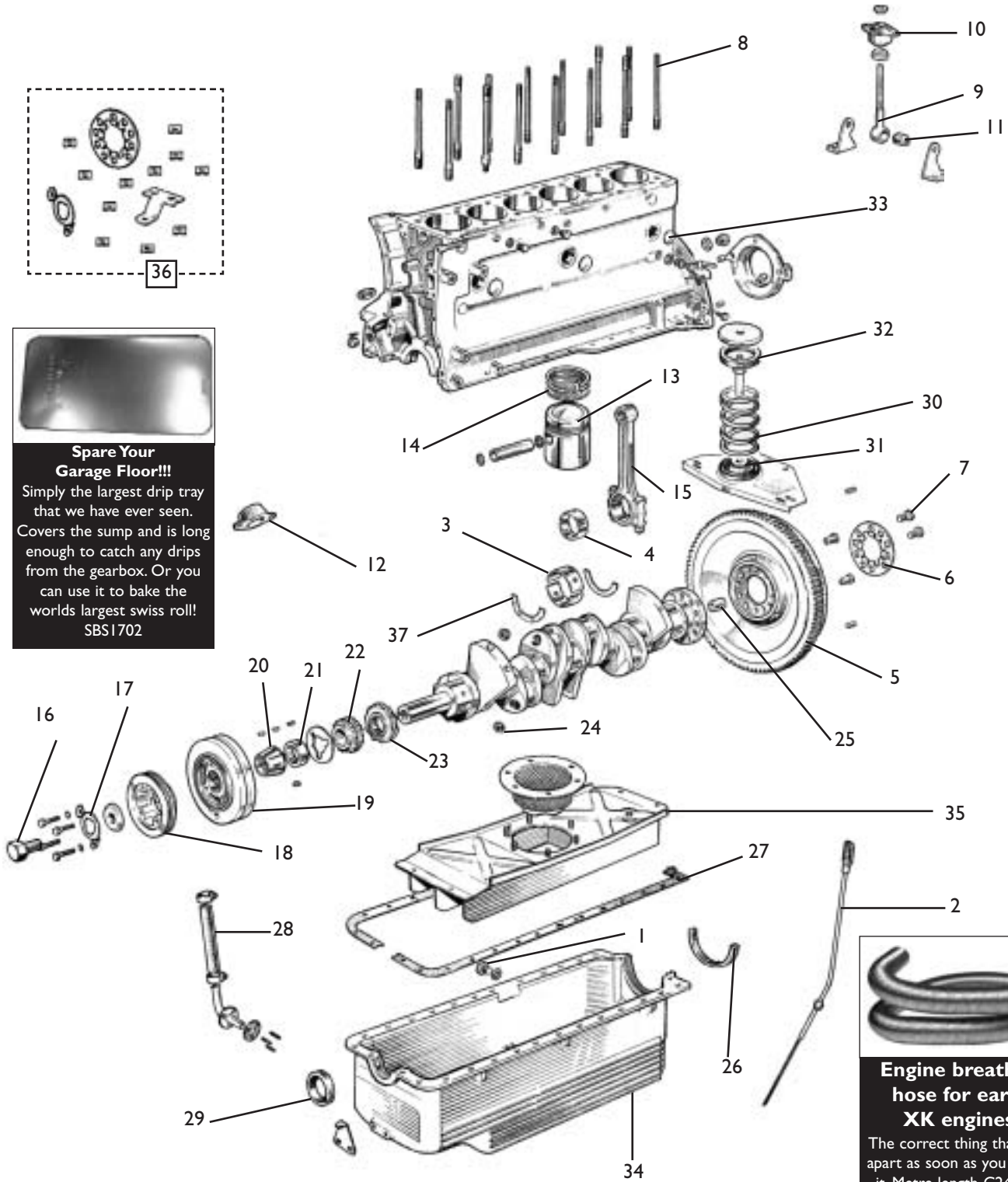

Engine breather hose for early XK engines
 The correct thing that falls apart as soon as you touch it. Metre length C2485/1



Independent Jaguar Spares Specialist

6 Cylinder XK Type Engine Block	
1. Sump drain plug washer	C23435 C2296/1
2. Oil level dipstick	
MK7/8/9	C8781
XK120	C2348/1
XK140 DHC/OTS	C8781
XK140 FHC	C10365
XK150 to V5059 & VSI303	C13277
XK150 V5060 & VSI304	C8781
MK1/2 2.4	C12620
MK1 3.4	C12896
MK2 3.4/3.8	C17527
S-TYPE	C22910/1
420	C22910/1
ESI 3.8	C21251
ESI 4.2	C21251
ES2 4.2	C21251
XJ6 3.4	EAC6713
XJ6 4.2	EAC6713
3. Crankshaft main bearings	
MK7/8 3.4 litre	M7118LC
MK9 3.8 litre	M7118LC
XK120/140/150 3.4 litre	M7118LC
XK150S 3.8	M7118LC
MK1/2 2.4	M7118LC
MK1 3.4	M7118LC
MK2 3.4/3.8	M7118LC
S-TYPE	M7118LC
MK10 3.8	M7118LC
420	M7294LC
ESI 3.8	M7118LC
ESI 4.2	M7294LC
ES2 4.2	M7294LC
MK10 4.2/420G	M7294LC
XJ6 3.4	M7373LC
XJ6 4.2	M7294LC
N.B.Available in Std to +40 sizes	
4. Connecting rod bearings	
All models	B6545LC
N.B.Available in Std to +40 sizes	
5. Manual gearbox flywheel	
MK7/8/9	C4809R
XK120/140/150	C4809R
MK1/2 2.4	C23170

MK1 3.4		CI4921R
MK2 3.4/3.8		CI4921R±
S-TYPE		CI4921R±
420		CI8517R±
ESI 3.8		CI4921R±
ESI 4.2		CI8517R±
ES2 4.2		CI8517R±
XJ6 2.8		C23328
XJ6 3.4		EAC1689
XJ6 4.2		EAC1689
± For ring gear only add suffix RG		
6. Flywheel lock tab		
All models		C4810
7. Flywheel bolts		
ALL MODELS manual		C4855
All models automatic		C6839
8. Cylinder head studs		
MK7 /8/9		C29035 x 13 164mm C2270 x 1 165mm
XK120/140/150		C29035 x 13 164mm C2270 x 1 165mm
MK1 2.4/3.4		C29035 x 13 164mm C2270 x 1 165mm
MK2 2.4	BG1001-BG9999 BH1001-BH9999 BJ1001-BJ3661	C29035 x 13 164mm C2270 x 1 165mm
	BJ3662 on 7J1001 on	C29035 x 10 164mm C23609 x 3 173mm C23610 x 1 175mm
MK2 3.4/3.8		C29035 x 10 164mm
S-TYPE/420		C23609 x 3 173mm C23610 x 1 175mm
ESI 3.8/MK10 3.8		C29035 x 13 164mm C2270 x 1 165mm
ESI 4.2 & ES2 4.2 to 7R1914 open & fhc 7R35388 2+2		C29035 x 10 164mm C23609 x 3 173mm C23610 x 1 175mm



Independent Jaguar Spares Specialist

MK2/S-TYPE/E SI 3.8/MK10 3.8	R16586	8:1
	R32592	9:1
420/E SI 4.2/E S2 4.2/MK10 4.2/420G	R39520	
XJ6 2.8	NLA	
XJ6 3.4	RTC2444	
XJ6 4.2 S1/2	RTC2443	
XJ6 4.2 S3	JLM324	
Please note early 4 ring sets are no longer available		
15. Crankshaft connecting rod		
All models except 2.4/2.8	RTC2995	
Connecting rod bolt	C32344	
Connecting rod nut	EAC5541	
16. Crankshaft pulley bolt		
MK1/2 2.4	C5896	
MK1/2 3.4/3.8	C5896	
S-TYPE	C5896	
MK10 3.8	C5896	
420	C23424	
MK10 4.2/420G	C23158	
ESI 3.8	C5896	
ESI 4.2	C5896	
ES2 4.2	C5896	
XJ6 3.4	C23424	
XJ6 4.2	C23424	
17 Pulley bolt locktab		
MK7/8/9	C2467	
XK120/140/150	C2467	
MK2 2.4	C2467	
MK2 3.4/3.8	C2467	
S-TYPE	C2467	
420	C2467	
ESI 3.8	C2467	
MK10 3.8	C2467	
ESI 4.2	C2467	
ES2 4.2	C23158	
MK10 4.2/420G	C23158	
XJ6 3.4	C23158	
XJ6 4.2	C23158	
18. Crankshaft pulley		
MK7/8	C7275	
MK9	C14589	
XK120 Early	C2469	
XK120 Late & XK140	C7275	
XK150 to V5732 & VS1522	C7275	
V5733 & VS1523 on	C14589	

MK1 3.4	to KE9999 & KF2500 KF2501 on	C7275 C14589
MK2 2.4	BG1001-BG9999 BH1001-BH3893	C14721
	BH3894-BH5364	C18904
	BH5365 on	C19527
	BJ6132 on 7J1001 on	C24921±
±This is a complete pulley and damper assembly.		
MK2 3.4	KG1001-KG9999 KH1001-KH4022	C18703
	KH4023 on IJ50001 on 340	C19517
MK2 3.8	LA1001-LA9999 LB1001-LC1671	C18703
	LC1672 on	C19517
MK10 3.8		C19517
S-TYPE		C19517
MK10 4.2/420G		C23363
420		C23363
ESI 3.8	R1001-I458 R1459-R5249 R5250 on	C14589 C18703 C19517
ESI 4.2		C24289
ES2 4.2		C23131
XJ6 All models non air con		C27754
XJ6 All models air con		C23131
19. Crankshaft damper		
MK7/8/9		C8020
XK120		C8020
XK140/150		C15274
MK1 2.4		C12037
MK1 3.4		C8020
MK2 2.4	BG1001-BG9999 BH1001-BH9999 BJ1001-BJ6131	C12037

SNG Barratt USA, 92 Londonderry Turnpike, Manchester, New Hampshire 03104, USA.
Telephone 603-622-1050 Orderline 1-800-452-4787 Fax 603 622 0849
E-Mail sales.usa@sngbarratt.com Website www.sngbarratt.com



Independent Jaguar Spares Specialist

MK2 3.4/3.8/340	C15274
S-TYPE	C15274
420	7F1001-7F1167
	7F1168 on
MK10 3.8	C15274
ESI 3.8	C15274
MK10 4.2/420G	EAC4050±
ESI 4.2	C24366R
ES2 4.2	EAC4050±
XJ6 3.4	C40111
XJ6 4.2	EAC4050
± Timing pointer may need relocation	
20. Crankshaft cone (All models)	C2466
21. Distance piece (All models)	C40147
22. Timing chain gear (All models)	C2170
23. Pump drive gear (most models)	C2314
24. Crankshaft sludge plug	
MK1/2 2.4	C4283
MK1/2 3.4/3.8	C4283
S-TYPE	C4283
MK10 3.8	C4283
420	C23761
MK10 4.2/420G	C23761
ESI 3.8	C4283
ESI 4.2	C23761
XJ6 3.4	C23761
XJ6 4.2	C23761
25. Spigot bearing	
All models to XJ6 Series 3	C2226
XJ6 Series 3	UKC8154J
26. Rear sump oil seal	
MK7/8//XK120/140 (cork)	C2302
MK2/E-Type/XJ S1/2/3 (rubber)	C36499
MK9/XK150/MK10/420G	
27. Sump gasket	C19590
28. Oil return hose	
XK150/MK1	C12382
E-Type S1/2	C15949
MK1/2/S-Type/420/MK10/	C12861
All XJ	EAC8531
29. Front sump oil seal	
XK120 & early MK7	C2306
All other models	EAC8815

30. Rear engine mounting (gearbox)			
XK120 Early		C478	mtg
XK120 Late		C12677	mtg
XK140/150 (overdrive)		C8281	mtg
MK7/8/9		C8281	mtg
MK1 (std)		C12298	spring
MK1 (non overdrive)		C12299	spring
MK2 2.4	100001-119199	C12298	spring
Std box	125001-127821		
O/D box	100001-119199	C12299	spring
	125001-127821		
Std & O/D	119200 on	C12299	spring
	127822 on		
	IJ1001 on		
	IJ30001 on		
All auto models		C45902/I	spring
MK2 3.4	150001-169340	C12298	spring
Std box	175001-180187		
	200001-210000		
O/D box	150001-169340	C12299	spring
	175001-180187		
Std & O/D	169341 on	C12299	spring
	180188 on		
MK2 3.8	230001-234124	C12298	spring
Std box	210001-224149		
O/D box	230001-234124	C12299	spring
	210001-224199		
Std & O/D	234125 on	C12299	spring
	224150 on		
All auto models		C45902/I	spring
S-TYPE 3.4/3.8		C12298	spring
Std box			
Std box		C19988	spring
3.4	1B2768 on 1B25380 on		
3.8	1B52998 on 1B76908 on		



Independent Jaguar Spares Specialist

O/D box		C12299	spring
O/D box		C19988	spring
3.4	IB2192 on IB25301 on		
3.8	IB52078 on IB76310		
All auto models		C45902/1	spring
420	Std & O/D	C19988	spring
	Auto	C12299	spring
ESI 3.8	850001-850648 875001-878888 860001-861061 885001-888081	C12677	bobbin
	850649 on 878889 on 861062 on 888082 on	C12299	spring
ESI 4.2		C12299	spring
ES2 4.2		C12299	spring
MK10/420G	Std & O/D	C19988	spring
	Auto	C12299	spring
XJ6 Ser 1	Std	C12298	spring
	O/D	C12299	spring
XJ6 Ser 2	Manual to 100780	C12299	spring
	Manual 100781 on	C12298	spring
	Auto Mod	C45902/1	spring
XJ6 Ser 3		C45902/1	spring
31. Rear engine spring centre bush			
E-Type S1/2/MK2/S-Type/420/MK10/420G		C12265	
V12 E-type & all XJ models		CAC3227	
32. Rear engine spring seat		CBC2517	
33. Core plug			
XK120/140/150 MK1/2 2.4/3.4/3.8	C315 x 7	41mm	
S-TYPE/MK10 3.8	C317 x 1	25mm	
MK10 4.2/420G 420 & ESI 4.2 &	C16862/2 x 1	23mm	
ES2 4.2 to 7R1914 & 7R 35388	C16862/8 x 6	41mm	

ES2 4.2	7R1915 on & 7R35389	C16862/2 x 1 C16862/5 x 4 C16862/8 x 9	23mm 32mm 41mm
XJ6 2.8		C317 x 2 C16862/2 x 1 C16862/8 x6/9	25mm 23mm 41mm
XJ6 3.4	Early to S3 337107 Late S3 337108 on Plus.....	C317 x 2 C16862/2 x 2 C16862/3 x 1 C16862/5 x 2 C16862/8 x 9	25mm 23mm 26mm 32mm 41mm
XJ6 4.2	Early S3 to 337430	C317 x 2 C16862/2 x 1 C16862/5 x 2 C16862/8 x 9	25mm 23mm 32mm 41mm
	Late S 3	C16862/2 x 3 C16862/5 x 2 C16862/8 x 9	26mm 32mm 41mm
34. Oil sump			
E-Type S1 3.8		C16750	
E-Type S1 3.8 late/S1/2 4.2		C24457	
XJ6		EAC1254	
35. Sump baffle			
E-Type S1/2		C16741	
Filter basket for C16741		C16742	
XJ6 S1/2/3 strainer		C33639	
36. Engine lock tab set			
3.4/3.8 engines		EN1034	
4.2 engines		EN1030	
37. Crankshaft thrust washers			
Standard size		C34744	
Oversize 0.004" approx		C34744/1	



Independent Jaguar spares specialists and manufacturer in Great Britain for over 25 years.

SNG Barratt USA, 92 Londonderry Turnpike, Manchester, New Hampshire 03104, USA.
Telephone 603-622-1050 Orderline 1-800-452-4787 Fax 603 622 0849
E-Mail sales.usa@sngbarratt.com Website www.sngbarratt.com